

vtech[®]
Baby

User's Manual

Sort and Learn Car



© 2012 VTech
Printed in China
91-002566-002 

VTech understands that a child's needs and abilities change as they grow and with that in mind we develop our toys to teach and entertain at just the right level...

vtech Baby

Toys that will stimulate their interest in different textures, sounds and colours

I am...

...responding to colours, sounds and textures

...understanding cause and effect

...learning to touch, reach, grasp, sit-up, crawl and toddle

Birth-36 months



Pre-School

Interactive toys to develop their imagination and encourage language development

I want...

...to get ready for school by starting to learn the alphabet and counting

...my learning to be as fun, easy and exciting as can be

...to show my creativity with drawing and music so my whole brain develops

3-6 years



Electronic Learning Computers

Cool, aspirational and inspiring computers for curriculum related learning

I need...

...challenging activities that can keep pace with my growing mind

...intelligent technology that adapts to my level of learning

...National Curriculum based content to support what I'm learning at school

4-10 years



To learn more about this and other VTech® products, visit www.vtechuk.com

INTRODUCTION

Rock along with puppy's musical shape sorting car! Pop the shape sorter pieces through the windows to hear cheerful tunes, fun sound effects, learn the shape names and count along. Press the piano keys on the front to learn colours, play musical notes or change the music tempo. When a melody is heard, insert shapes to hear sound effects played over it! Pull along to activate fun phrases, a sing-along song and to hear the dog sing you a tune as he rocks along from side to side! Headlights flash along with the responses. Pieces store neatly inside the car, just open the boot to release them. The pull-along cord packs safely away in the battery compartment for early play.

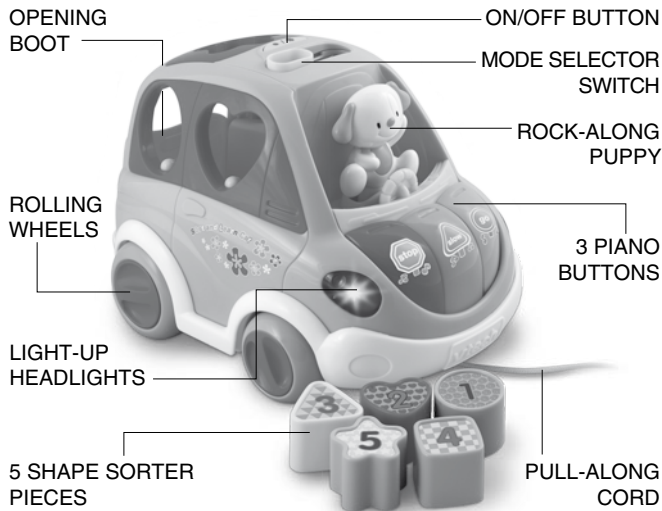

INCLUDED IN THIS PACKAGE

- One VTech® Sort and Learn Car
- Five shape sorter pieces
- One instruction manual

WARNING:

All packing materials, such as tape, plastic sheets, packaging locks and tags are not part of this toy, and should be discarded for your child's safety.

NOTE:

Please keep this instruction manual as it contains important information.

INSTRUCTIONS

BATTERY INSTALLATION

1. Make sure the unit is turned **OFF**.
2. Locate the battery cover on the bottom of the unit. Use a coin or a screwdriver to loosen the screw.
3. Install 2 new "AA" (AM-3/LR6) batteries following the diagram inside the battery box. (The use of new alkaline batteries is recommended for maximum performance.)
4. Replace the battery cover and tighten the screw to secure.

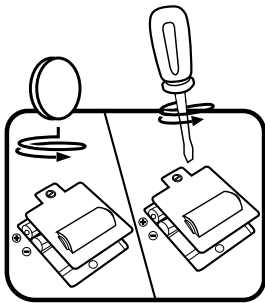

BATTERY NOTICE

- Use new alkaline batteries for maximum performance.
- Use only batteries of the same or equivalent type as recommended.
- Do not mix different types of batteries: alkaline, standard (carbon-zinc) or rechargeable (Ni-Cd, Ni-MH), or new and used batteries.
- Do not use damaged batteries.
- Insert batteries with the correct polarity.
- Do not short-circuit the battery terminals.
- Remove exhausted batteries from the toy.
- Remove batteries during long periods of non-use.
- Do not dispose of batteries in fire.
- Do not charge non-rechargeable batteries.
- Remove rechargeable batteries from the toy before charging (if removable).
- Rechargeable batteries are only to be charged under adult supervision.

DO NOT USE RECHARGEABLE BATTERIES.

Disposal of batteries and product



The crossed-out wheellie bin symbols on products and batteries, or on their respective packaging, indicates they must not be disposed of in domestic waste as they contain substances that can be damaging to the environment and human health.



The chemical symbols Hg, Cd or Pb, where marked, indicate that the battery contains more than the specified value of mercury (Hg), cadmium (Cd) or lead (Pb) set out in Battery Directive (2006/66/EC).

The solid bar indicates that the product was placed on the market after 13th August, 2005.

Help protect the environment by disposing of your product or batteries responsibly.

For more information, please visit:

www.recycle-more.co.uk

www.recyclenow.com

PRODUCT FEATURES

1. On/Off Button

To turn the unit on, press the **On/Off** button on the top. To turn the unit off, press the **On/Off** button again.

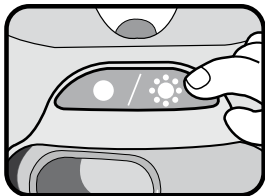

2. Automatic Shut-off

To preserve battery life, the **VTech® Sort and Learn Car** will automatically power-down after 30 seconds without input. The unit can be turned on again by inserting a shape, pressing any button or by pushing or pulling the car.

3. Modes of Play

The two modes of play are **Learning** and **Music**.

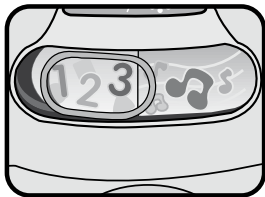

ACTIVITIES

1. To turn the unit on, press the **On/Off** button on top of the car.

In **Learning Mode**, you will hear sounds, phrases and a sing-along song.

In **Music Mode**, you will hear sounds, phrases and a melody.

The headlights will flash with the sounds.

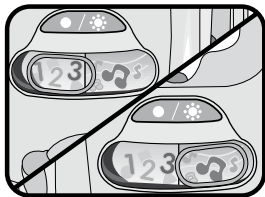

2. Insert the **Shape Sorter Pieces** into the correct spaces.

In **Learning Mode** you will hear the shape identified, fun phrases and sound effects.

In **Music Mode**, you will hear the shape identified and a melody. When a melody is playing, insert the **Shape Sorter Pieces** again and a variety of fun sounds be heard over the melody.

Open the boot to release the shapes.

The headlights will flash with the sounds.

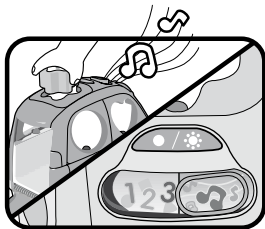
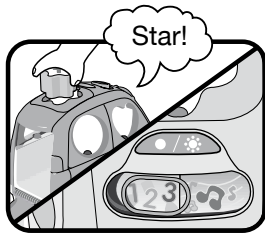

3. Press the **Three Piano Buttons** on the bonnet of the car.

In **Learning Mode** you will hear the colours identified, road safety phrases and a shape finding game. Correctly find the shape within 5 seconds to hear a short rewarding tune. Answer incorrectly or after 5 seconds and you will hear the normal reaction of the shape button.

In **Music Mode**, you can play musical notes.

When a melody is playing, press the **Green Piano Button** to speed up the tempo, **Yellow Piano Button** to slow down the tempo or the **Red Piano Button** to stop the melody.

The headlights will flash with the sounds.

4. Pull or push the car along (the pull-along cord can be found or stored away in the battery compartment).

In **Learning Mode** you will hear fun phrases or a sing-along song.

In **Music Mode**, you will hear the sing-along song and melodies sung by the dog.

The headlights will flash with the sounds.

The dog will rock from side to side as the car is pulled along.

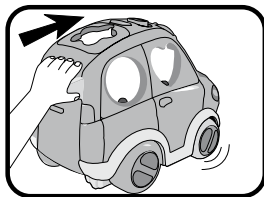
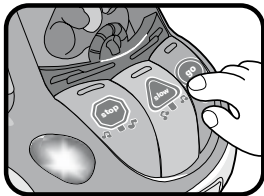

5. If there is no input to the unit after approximately 10 seconds, you will be asked to find a piano key. After another 10 seconds if there is still no input, the unit will play the theme song. If there continues to be no input to the unit, it will say “bye bye“, then enter into sleep mode.

MELODY LIST

1. London Bridge
2. The Wheels on the Bus
3. Oh My Darling Clementine
4. This Old Man
5. Pop Goes The Weasel
6. Twinkle, Twinkle Little Star

SING-ALONG SONG LYRICS (To the tune of London Bridge)

Make the road a safer place,
All hold hands,
Please don't race!
Stop and listen,
Look both ways,
When you're crossing.

CARE & MAINTENANCE

1. Keep the unit clean by wiping it with a slightly damp cloth.
2. Keep the unit out of direct sunlight and away from any direct heat source.
3. Remove the batteries when the unit will not be in use for an extended period of time.
4. Do not drop the unit on hard surfaces and do not expose the unit to moisture or water.

TROUBLESHOOTING

If for some reason the program/activity stops working or malfunctions, please follow these steps:

1. Please turn the unit **OFF**.
2. Interrupt the power supply by removing the batteries.
3. Let the unit stand for a few minutes, then replace the batteries.
4. Turn the unit **ON**. The unit should now be ready to play again.
5. If the product still does not work, replace with a new set of batteries.

If the problem persists, please call our Consumer Services Department on 01235 546810 (from UK) or +44 1235 546810 (outside UK) and a service representative will be happy to help you.

IMPORTANT NOTE:

Creating and developing **VTech®** products is accompanied by a responsibility that we take very seriously. We make every effort to ensure the accuracy of the information, which forms the value of our products. However, errors sometimes can occur. It is important for you to know that we stand behind our products and encourage you to call our Consumer Services Department on 01235 546810 (from UK) or +44 1235 546810 (outside UK), with any problems and/or suggestions that you might have. A service representative will be happy to help you.

CLASS 1
LED PRODUCT



PRODUCT WARRANTY



Thank you for choosing this quality product from VTech. We hope it will bring many hours of entertainment, imaginative play and learning.

1. The product detailed above is covered by a one year warranty from the date of purchase, against any defects in materials or workmanship.
2. The product may be returned to the place of purchase. Alternatively the product can be returned to VTech Electronics Europe plc (see address below), with proof of purchase, without proof of purchase no replacement will be provided.
3. VTech Electronics Europe plc will examine the product and if it is found to be defective due to faulty materials or workmanship, will replace the product at their discretion.
4. If the product covered by this warranty is damaged due to misuse, modification or unauthorised repair, or because of faulty batteries, battery discharge or incorrect electrical connections, then this warranty becomes void.
5. This warranty is personal to the original purchaser and is not transferable.
6. Breakages to the LCD screen are not covered by the warranty.
7. Returns to VTech Electronics Europe plc should include a cheque or postal order for £1.50 towards the cost of return postage and packaging.
8. Products returned to VTech Electronics Europe plc, should be addressed as follows and packed carefully to avoid damage in transit (Please do not include batteries or adaptor).
Please include details of the fault together with your name and address.

VTech Electronics Europe plc, c/o Tablogix Limited, 200 Milton Park, Abingdon, Oxon OX14 4TA

THIS WARRANTY IS OFFERED AS AN EXTRA BENEFIT AND DOES NOT AFFECT CONSUMERS' STATUTORY RIGHTS.

This warranty is valid for the UK and Eire only. For products purchased outside the UK and Eire, please contact your local distributor or place of purchase.

Join the VTech club online at www.vtechuk.com

